

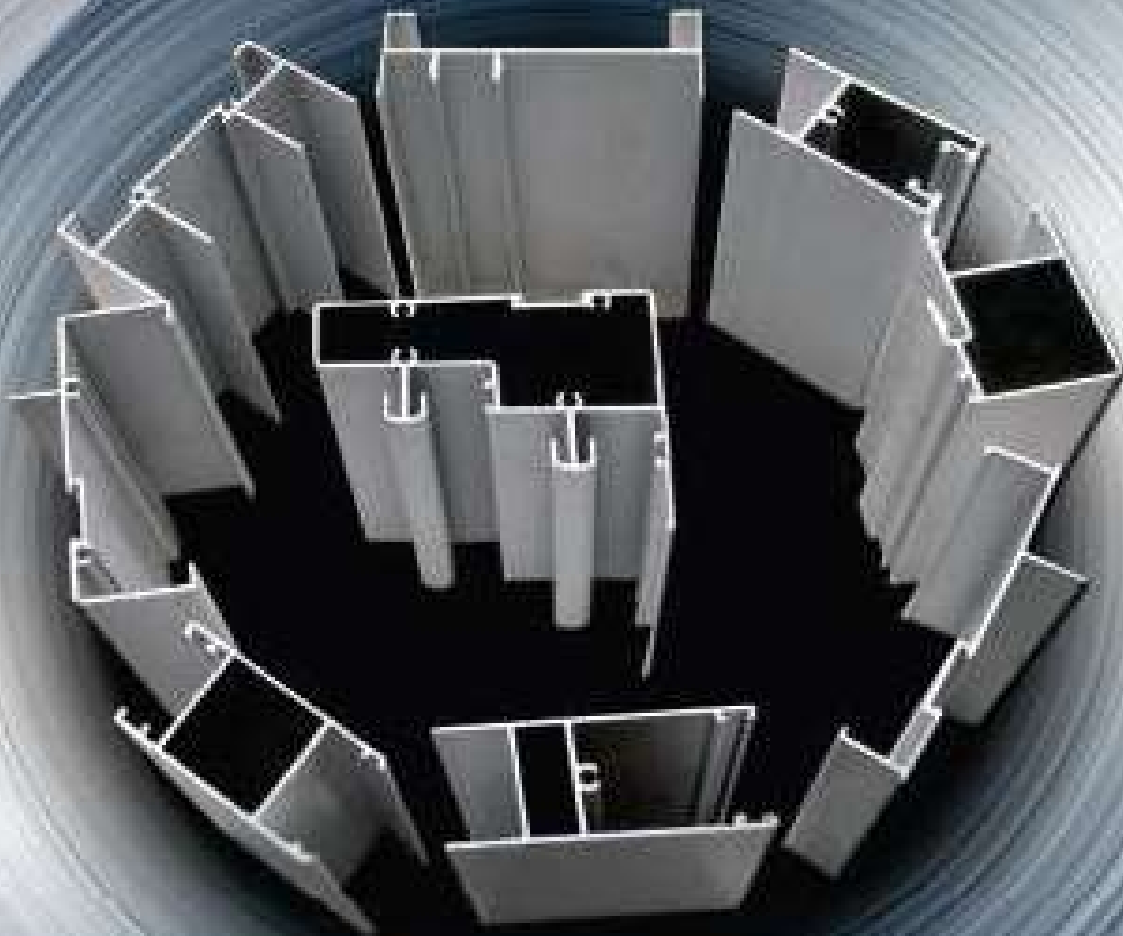

High
Performance
Delivered



Proud to make in India

www.ryextrusion.com

Company

- **Aluminium Alloy Sections:** Manufacture 5mm to 125mm cross sectional diameter profiles for industrial and commercial use
- **Mumbai:** Operate three million dollar 100,000 sqft automated manufacturing facility located near Mumbai
- **Data Driven–Quality Focused:** Practice precision manufacturing using latest technology to provide best quality



Product and Services

- **50 Industrial SKUs:** Serve a mix of HVAC, pharmaceutical, furniture, marketing displays and electrical panel industry
- **445 Commercial SKUs:** Supply doors, windows and construction industry with 90 profiles in 5 different weight ranges
- **Value Added Services:** Provide additional services such as die design, die development, color anodizing, customized size etc.

We produce world class aluminium profiles using precision manufacturing technology

ARCHITECTURAL SECTIONS

Flat Bar

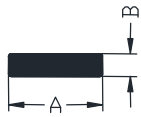

SECTION NO	TYPE	A (mm)	B (mm)	WT (Kg/Mtr)
RY1200	Flat Bar	100	10	2.800
RY1201		25	6	0.380
RY1202		38	6	0.620
RY1203		40	4	0.400
RY1204		18	2.9	0.140
RY1205		60	5	0.810
RY1206		70	5	0.950
RY1207		110	5	1.485
RY1208		50	5	0.675
RY1209		33	4	0.360
RY1210		14	3	0.115
RY1211		19	3	0.155
RY1212		21	3	0.170
RY1213		38	3	0.310
RY1214		50	25	3.380
RY1215		31	19	1.550
RY1216		75	6	1.200
RY1217		63	12	2.150
RY1218	20	6	0.390	

Angle

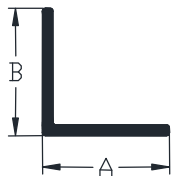

SECTION NO	TYPE	A (mm)	B (mm)	WT (Kg/12')
RY0860	Angle	25	25	0.800 – 1.000
RY0870	Angle	18	18	0.600 – 0.800
RY0890	Angle	36	24	1.060 – 1.200
				1.200 – 1.400
RY0900	Angle	38	38	1.800 – 2.000
RY0910	Angle	50	50	2.800 – 3.000

L Pipe RY0780

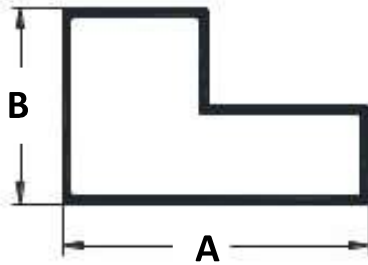

A (mm)	B (mm)	WT (Kg/12')
38	24	1.200 – 1.400
		1.400 – 1.600

L Pipe

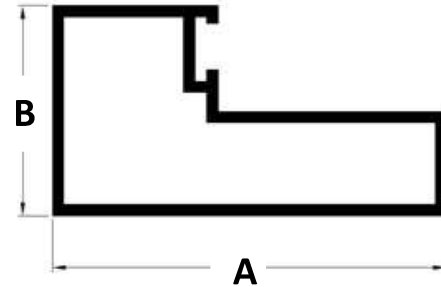

A (mm)	B (mm)	WT (Kg/12')
45	24	1.800 – 1.900

Square Pipe

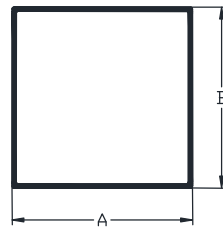

SECTION NO	TYPE	A (mm)	B (mm)	WT (Kg/12')
RY0640	Square Tube	38	38	1.600 – 1.800
				1.800 – 2.000
RY0650		50	50	2.000 – 2.200
				2.500 – 3.000
RY06		25	25	0.900 – 1.000

Rectangular Tube



SECTION NO	TYPE	A (mm)	B (mm)	WT (Kg/12')
RY0660	Rectangle Tube	25	12.4	0.800 – 1.000
		36	23	0.850 – 0.900
RY0670	Rectangle Tube	38	24	0.800 – 1.000
				1.000 – 1.200
				1.200 – 1.400
				1.400 – 1.600
				1.600 – 1.800
RY0680	Rectangle Tube	50	24	1.000 - 1.200
				1.400 – 1.600
				2.200 – 2.400
				2.400 – 2.600
				2.600 - 2.800
				2.800 – 3.000
		50	38	2.300 – 2.400
RY0690	Rectangle Tube	63	24	1.400 - 1.600
				1.600 – 1.800
				1.800 – 2.000
RY0710	Rectangle Tube	63	38	1.400 – 1.600
				1.600 – 1.800
				1.800 – 2.000
				2.200 – 2.400
				2.400 – 2.600
	Rectangle Tube	76	24	2.600 – 2.800
				2.900 – 3.100
				1.500 – 1.600
				1.800 – 2.000
				2.100 – 2.300
				3.000 – 3.100

Rectangular Tube



SECTION NO	TYPE	A (mm)	B (mm)	WT (Kg/12')
RY	Rectangle Tube	82	38	3.000 – 3.300
				3.500 – 3.800
RY	Rectangle Tube	100	24	2.000 – 2.100
				2.300 – 2.600
				3.300 – 3.500
RY	Rectangle Tube	100	38	3.700 – 3.900
RY	Rectangle Tube	101	50	3.700 – 3.800
RY	Rectangle Tube	123	24	3.200 – 3.300
				3.800 – 4.100

Single Track Top ¾ Inch

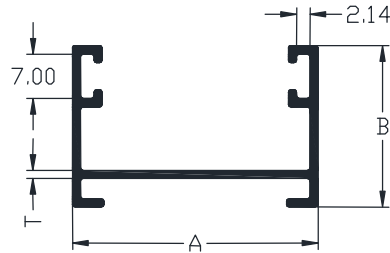

SECTION NO	TYPE	A (mm)	B (mm)	WT (Kg/12')
RY0220	1 Track Top	39	25.6	1.200 – 1.400
				1.400 – 1.600

Single Track Bottom ¾ Inch

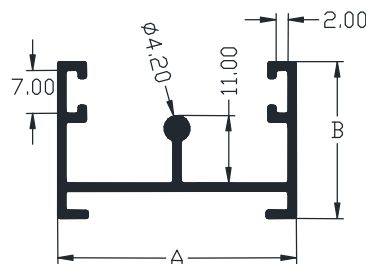

SECTION NO	TYPE	A (mm)	B (mm)	WT (Kg/12')
RY0230	1 Track Bottom	39	25.6	1.400 – 1.600
				1.600 – 1.800

Two Track Top 3/4 Inch

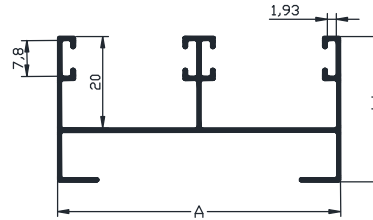

SECTION NO	TYPE	A (mm)	B (mm)	WT (Kg/12')
RY0240	2 Track Top	61.85	31.75	1.200 – 1.400
				1.400 – 1.600
				1.600 – 1.800
				1.800 – 2.000
				2.000 – 2.200
				2.200 – 2.400

Two Track Bottom 3/4 Inch

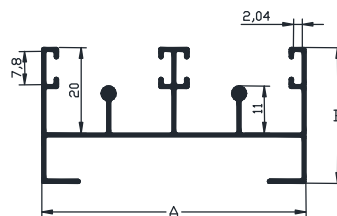

SECTION NO	TYPE	A (mm)	B (mm)	WT (Kg/12')
RY0250	2 Track Bottom	61.85	31.75	1.600 – 1.800
				1.800 – 2.000
				2.000 – 2.200
				2.400 – 2.600

Three Track Top ¾ Inch

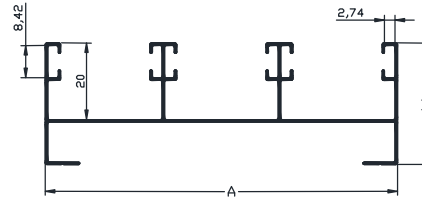

SECTION NO	TYPE	A (mm)	B (mm)	WT (Kg/12')
RY0260	3 Track Top	92.00	31.75	1.800 – 2.000
				2.000 – 2.200
				2.200 – 2.400
				2.400 – 2.600
				2.600 – 2.800
				2.800 – 3.000
				3.000 – 3.500

Three Track Bottom ¾ Inch

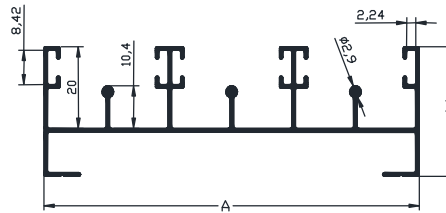

SECTION NO	TYPE	A (mm)	B (mm)	WT (Kg/12')
RY0280	3 Track Bottom	92.00	31.75	2.400 – 2.600
				2.600 – 2.800
				2.800 – 3.000
				3.000 – 3.200
				3.200 – 3.400
				4.000 – 4.200
				4.200 – 4.400
				4.400 – 4.600

Four Track Top 3/4 Inch

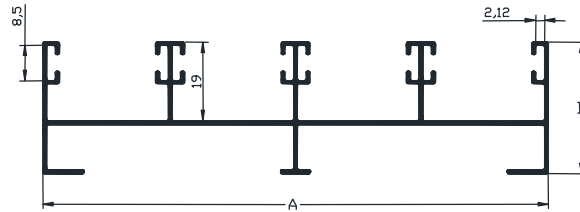

SECTION NO	TYPE	A (mm)	B (mm)	WT (Kg/12')
RY0310	4 Track Top	122.2	31.75	3.000 – 3.200
				3.200 – 3.400
				3.400 – 3.600
				3.600 – 3.800
				3.800 – 4.000
				4.000 – 4.200
				5.000 – 5.200

Four Track Bottom 3/4 Inch

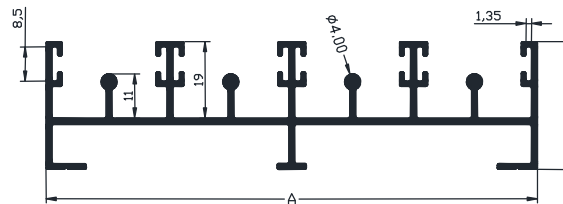

SECTION NO	TYPE	A (mm)	B (mm)	WT (Kg/12')
RY0320	4 Track Bottom	122.2	31.75	3.700 – 3.900
				4.200 – 4.400
				4.400 – 4.600
				4.600 – 4.800
				4.800 – 5.000
				5.000 – 5.200
				6.000 – 6.200

Five Track Top ¾ Inch

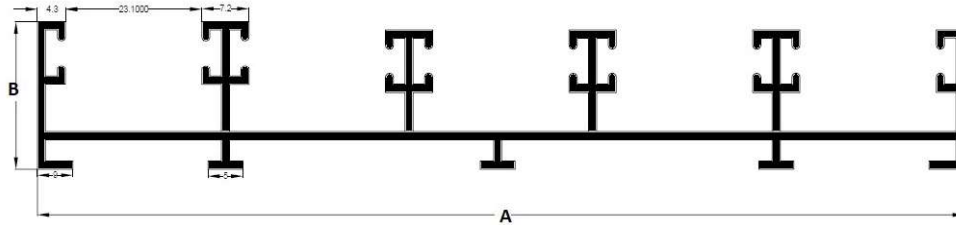

SECTION NO	TYPE	A (mm)	B (mm)	WT (Kg/12')
	5 Track Top	155	25	4.600 – 4.800
				4.900 – 5.100

Five Track Bottom ¾ Inch

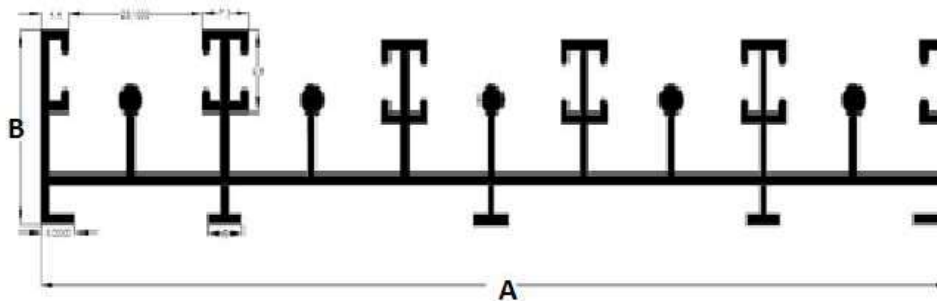

SECTION NO	TYPE	A (mm)	B (mm)	WT (Kg/12')
	5 Track Bottom	153.2	31.75	6.200 – 6.400

Handle ¾ Inch

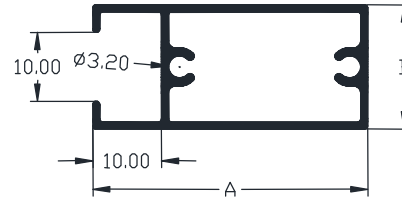

SECTION NO	TYPE	A (mm)	B (mm)	WT (Kg/12')
RY0100	Handle	40	18	0.900 – 1.000
				1.000 – 1.200
				1.300 – 1.400
				1.400 – 1.500
				1.500 – 1.600
				1.900 – 2.000

Interlock ¾ Inch

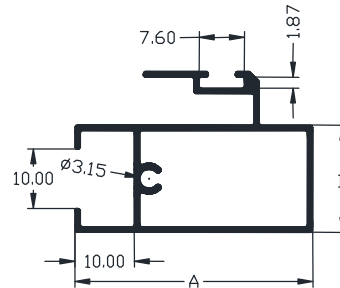

SECTION NO	TYPE	A (mm)	B (mm)	WT (Kg/12')
RY0110	Interlock	40	18	1.300 – 1.400
				1.400 – 1.500
				1.500 – 1.600
				1.600 – 1.700
				1.800 – 1.900
				2.100 – 2.200

Top Bottom 3/4 Inch

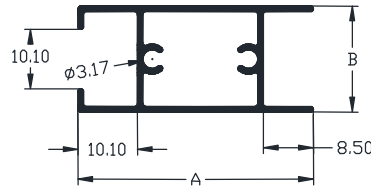

SECTION NO	TYPE	A (mm)	B (mm)	WT (Kg/12')
RY0130	Top Bottom	40	18	0.900 – 1.000
				1.000 – 1.200
				1.200 – 1.400
				1.400 – 1.600
				1.600 – 1.800
				1.800 – 2.000

Bearing Bottom 3/4 Inch

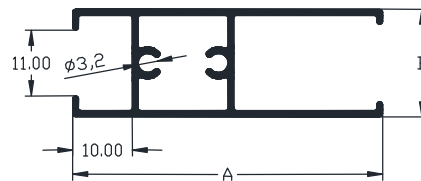

SECTION NO	TYPE	A (mm)	B (mm)	WT (Kg/12')
RY0140	Bearing Bottom	50	18	1.200 – 1.300
				1.400 – 1.500
				1.500 – 1.600
				1.600 – 1.700
				1.900 – 2.000
				2.000 – 2.200

Middle ¾ Inch

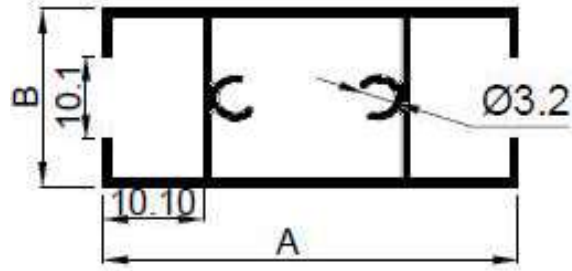

SECTION NO	TYPE	A (mm)	B (mm)	WT (Kg/12')
RY0150	Middle	42	18	1.200 – 1.300
				1.400 – 1.500

Two Track Top 1 Inch

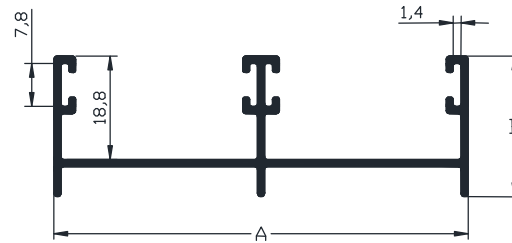

SECTION NO	TYPE	A (mm)	B (mm)	WT (Kg/12')
	2 Track Top 1"	75.5	25.6	2.200 – 2.400
				2.400 – 2.600

Two Track Bottom 1 Inch

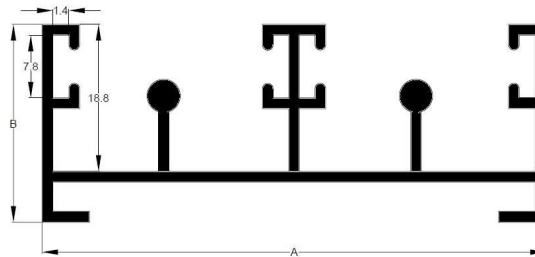

SECTION NO	TYPE	A (mm)	B (mm)	WT (Kg/12')
		75.5	25.6	2.500 - 2.600
				2.600 – 2.900

Three Track Top 1 Inch

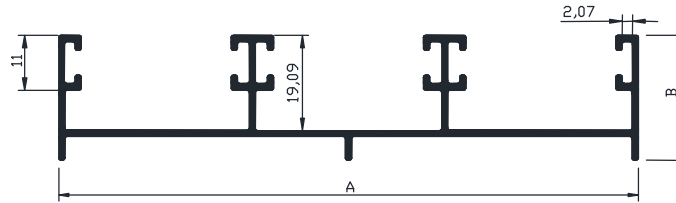

SECTION NO	TYPE	A (mm)	B (mm)	WT (Kg/12')
RY0430	3 Track Top 1"	75.5	25.6	2.900 - 3.000
				3.200 - 3.400
				3.400 - 3.600
				3.600 - 3.800
				3.800 - 4.000

Three Track Bottom 1 Inch

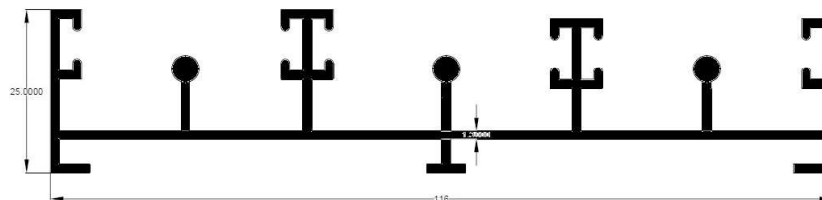

SECTION NO	TYPE	A (mm)	B (mm)	WT (Kg/12')
	3 Track Bottom 1"			4.100 - 4.300
				4.300 - 4.800

Bearing Bottom 1 Inch

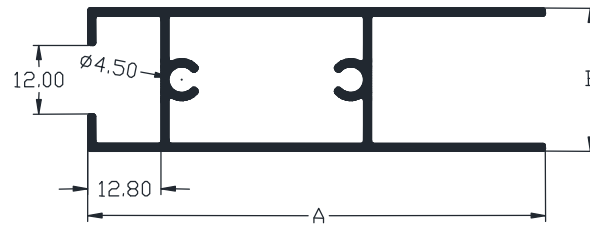

SECTION NO	TYPE	A (mm)	B (mm)	WT (Kg/12')
RY0930	Bearing Top Bottom	25	60	3.000 - 3.200

25 X 65 Interlock

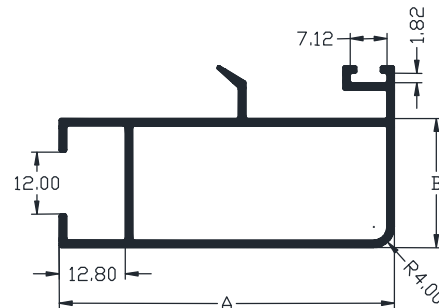

SECTION NO	TYPE	A (mm)	B (mm)	WT (Kg/12')
RY0940	Interlock 1 Inch	65	25	3.000 - 3.200

Handle 1 Inch

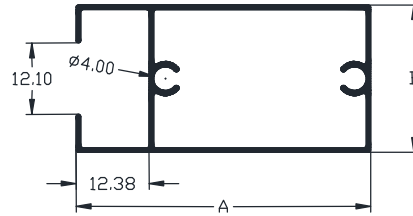

SECTION NO	TYPE	A (mm)	B (mm)	WT (Kg/12')
RY0330	Handle	50	25	1.400 – 1.600
				1.600 – 1.800
				1.800 – 2.000
				2.000 – 2.200
				2.200 – 2.400

Interlock 1 Inch

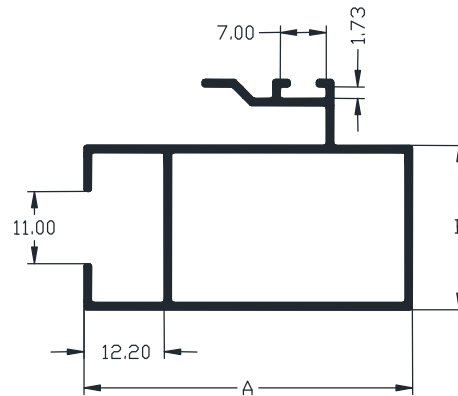

SECTION NO	TYPE	A (mm)	B (mm)	WT (Kg/12')
RY0340	Interlock	50	25	1.800 – 2.000
				2.000 – 2.200
				2.200 – 2.400
				2.600 – 3.000

Bearing Bottom 1 Inch

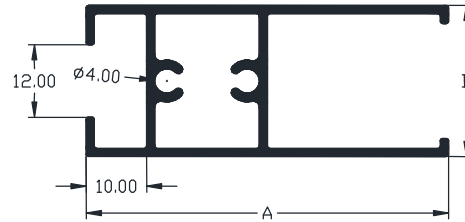

SECTION NO	TYPE	A (mm)	B (mm)	WT (Kg/12')
RY0210	Bearing Bottom	60.00	25.00	2.200 – 2.400
				2.400 – 2.600
				2.600 – 2.800

Handle 25X65

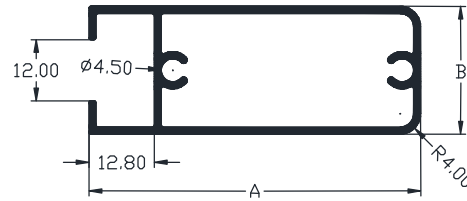

SECTION NO	TYPE	A (mm)	B (mm)	WT (Kg/12')
RY0950	Handle 25X65	65	25	2.900 - 3.200

Interlock 25X65

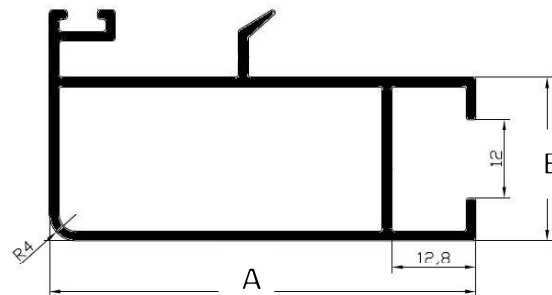

SECTION NO	TYPE	A (mm)	B (mm)	WT (Kg/12')
RY0951	Handle 25X65	65	25	3.150 - 3.250

Handle 18x50

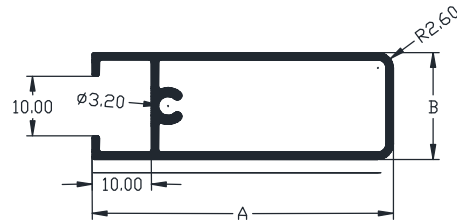

SECTION NO	TYPE	A (mm)	B (mm)	WT (Kg/12')
RY0160	Handle	50.8	18	1.600 – 1.800
				1.800 – 2.000
				2.000 – 2.200

Interlock 18x50 Without Leg

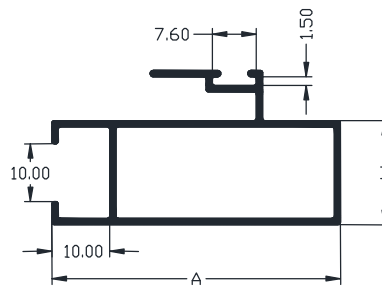

SECTION NO	TYPE	A (mm)	B (mm)	WT (Kg/12')
RY0170	Interlock	50	18	1.700 – 1.800
				1.800 – 2.000
				2.000 – 2.200

Interlock 18x50 With Leg

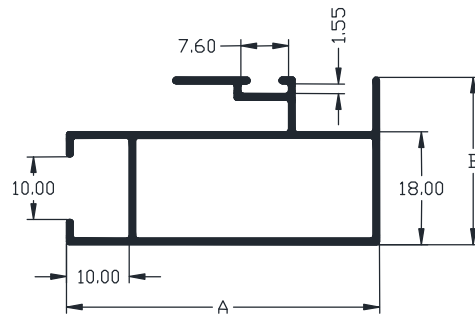

SECTION NO	TYPE	A (mm)	B (mm)	WT (Kg/12')
RY0180	Interlock	50.00	26.70	1.700 – 1.800
				1.800 – 2.000
				2.000 – 2.200

Handle 18x60

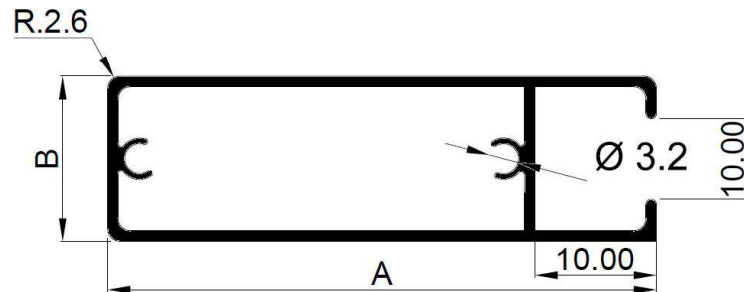

SECTION NO	TYPE	A (mm)	B (mm)	WT (Kg/12')
	Handle			1.900 – 2.000
				2.000 – 2.200

Interlock 18x60

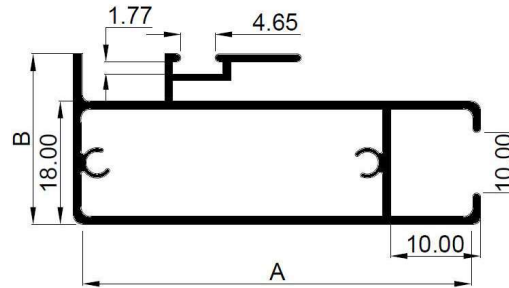

SECTION NO	TYPE	A (mm)	B (mm)	WT (Kg/12')
	Interlock 18X60	60	18	1.900 – 2.000
				2.000 – 2.200
				2.200 – 2.500

Bearing Bottom 18X60

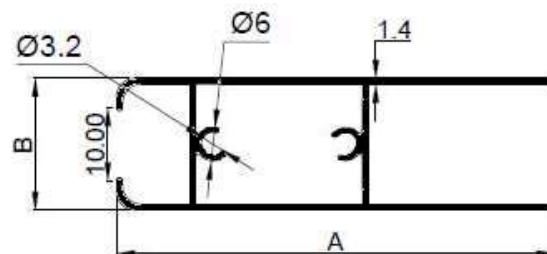

SECTION NO	TYPE	A (mm)	B (mm)	WT (Kg/MTR)
Bearing Bottom 18X60	HOLLOW	60	18	0.670 – 0.770

2X1 Handle

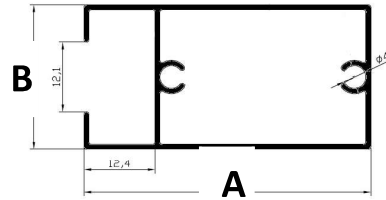

SECTION NO	TYPE	A (mm)	B (mm)	WT (Kg/12')
RY	Handle	50.00	25	1.500 – 1.600

2X1 Interlock

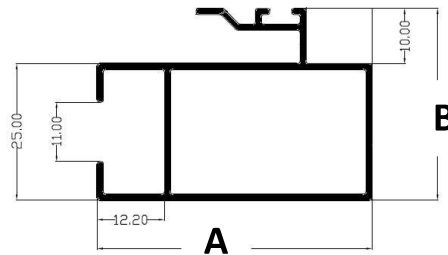

SECTION NO	TYPE	A (mm)	B (mm)	WT (Kg/12')
RY	Interlock	50	35	2.100 – 2.200

2X1 Middle

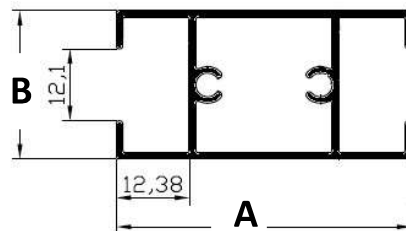

SECTION NO	TYPE	A (mm)	B (mm)	WT (Kg/12')
RY	Interlock	50	35	2.100 – 2.200

3X1 Handle

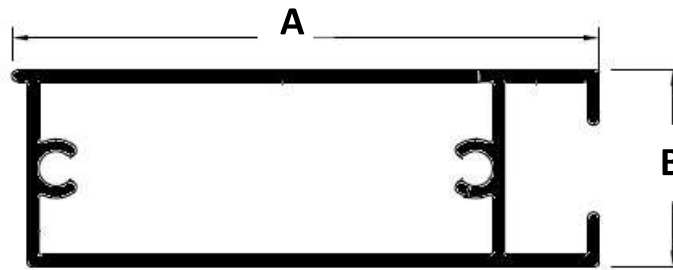

SECTION NO	TYPE	A (mm)	B (mm)	WT (Kg/12')
RY	Handle	75.5	25.05	3.300 – 3.400

3X1 Middle

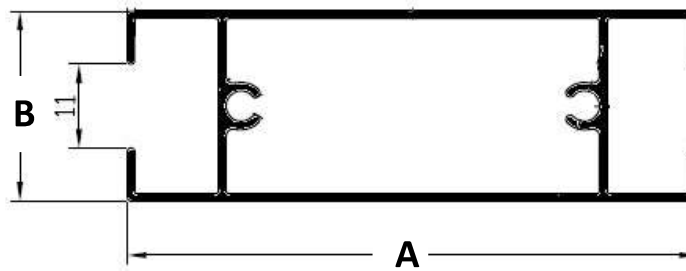

SECTION NO	TYPE	A (mm)	B (mm)	WT (Kg/12')
RY	Interlock	75	25	2.300 – 2.400

Single Partition

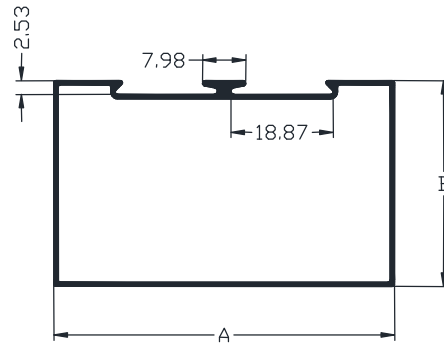

SECTION NO	TYPE	A (mm)	B (mm)	WT (Kg/12')
RY0450	Single Partition	63	38	1.800 – 2.000
				2.200 – 2.400
				2.400 – 2.600
				2.600 – 2.800
				2.800 – 3.000
				3.400 – 3.600
RY0470	Single Partition	100	44	6.000 – 6.200
				3.800 – 4.000
				4.500 – 4.800

Double Partition

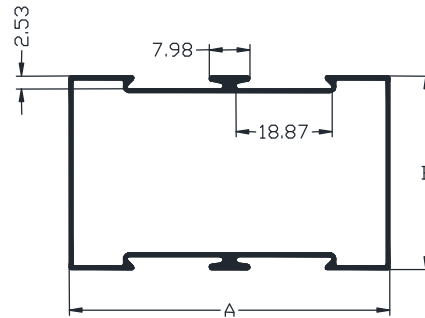

SECTION NO	TYPE	A (mm)	B (mm)	WT (Kg/12')
RY0460	Double Partition	63	38	1.800 – 2.000
				2.200 – 2.400
				2.400 – 2.600
				2.600 – 2.800
				2.800 – 3.000
				5.000 – 5.200
RY0480	Double Partition	100	44	3.900 – 4.100
				5.000 – 5.200

Leg Partition

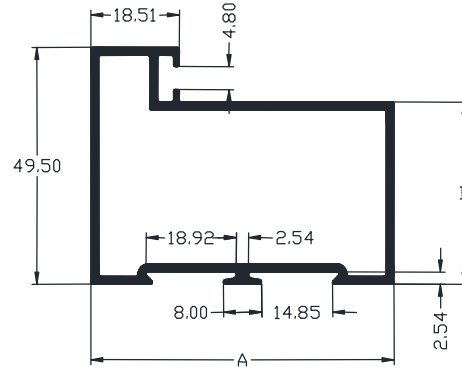

SECTION NO	TYPE	A (mm)	B (mm)	WT (Kg/12')
RY0610	Leg Partition	63.5	38.1	3.200 – 3.400
				4.000 – 4.200

Glazing Clip

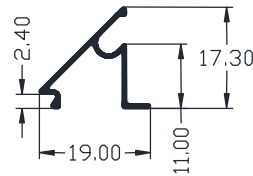

SECTION NO	TYPE	WT (Kg/12')
RY0490	Glazing Clip	0.240 – 0.270
		0.330 – 0.350
		0.350 – 0.370
		0.450 – 0.470

Door Vertical

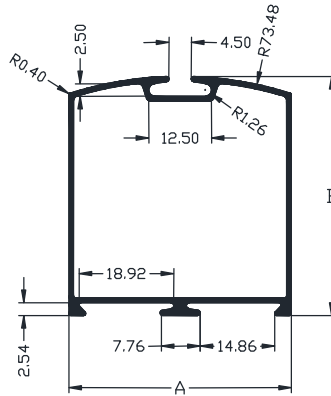

SECTION NO	TYPE	A (mm)	B (mm)	WT (Kg/12')
RY0510	Door Vertical	45.00	47.00	2.600 – 2.800
				3.400 – 3.600
RY	Door Vertical	44.45	47.62	2.700 – 2.800
RY0560	Door Vertical	45.00	85.00	5.000 – 5.200
				5.800 – 6.000

Door Top

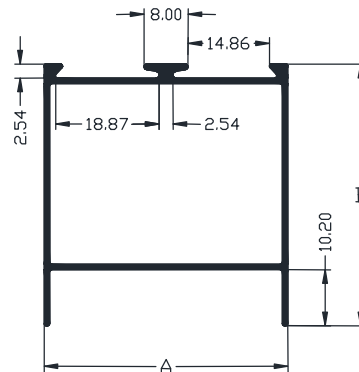

SECTION NO	TYPE	A (mm)	B (mm)	WT (Kg/12')
RY	Door Top	44.45	47.62	2.700-2.800
RY0520	Door Top	45.00	47.00	2.600 – 2.800
				3.500 – 3.700
RY0570	Door Top	45.00	85.00	4.800 – 5.000
				5.800 – 6.000

Door Middle Single

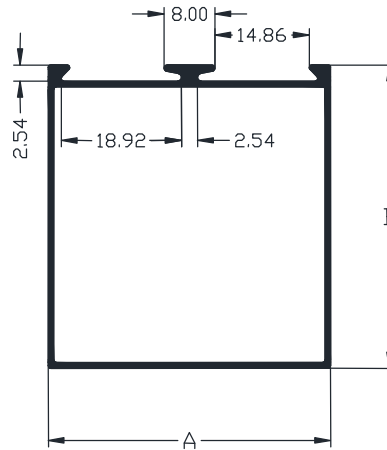

SECTION NO	TYPE	A (mm)	B (mm)	WT (Kg/12')
RY0530	Door Middle Single	45.00	47.00	2.800 – 3.000
RY0580	Door Middle Single	45.00	85.00	4.800 – 5.000
				5.800 – 6.000

Door Middle Double

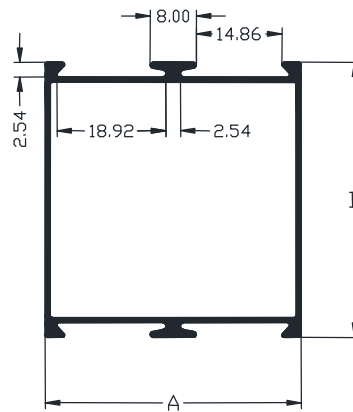

SECTION NO	TYPE	A (mm)	B (mm)	WT (Kg/12')
RY0540	Door Middle Double	45.00	47.00	2.500 – 2.700
				3.400 – 3.600

2 Track Bottom Hollow

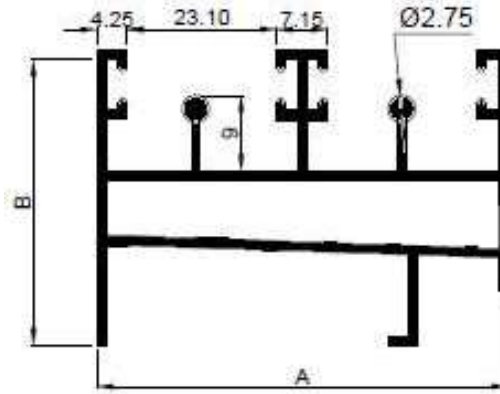

SECTION NO	TYPE	A (mm)	B (mm)	WT (Kg/12')
2 Track Bottom	Hollow	61.85	45.5	2.800

3 Track Bottom Hollow

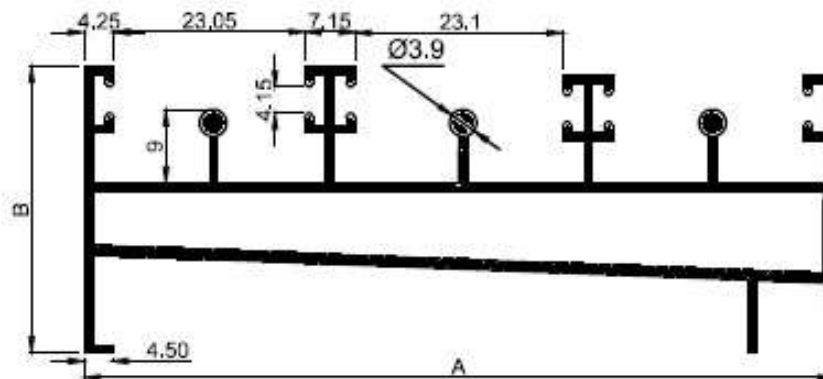

SECTION NO	TYPE	A (mm)	B (mm)	WT (Kg/12')
3 Track Bottom	Hollow	92	45.5	5.800-6.200

Domal-1151
2-TARCK

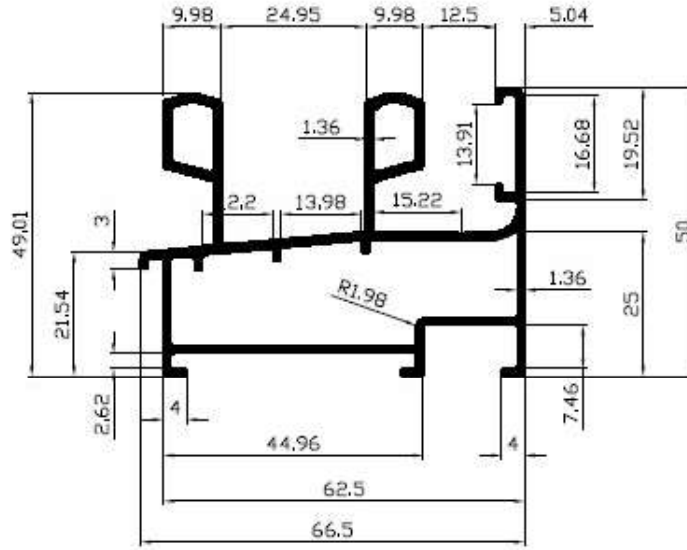

Wt: 4480KG/12'

Domal-1152
3-TRACK

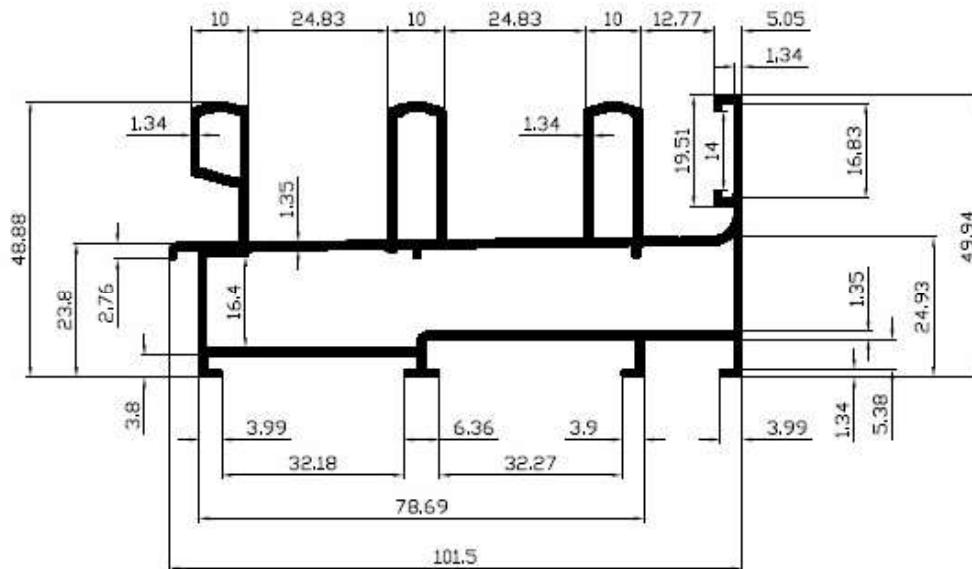

Wt: 6500 KG/12'

RA-01
20 X 54

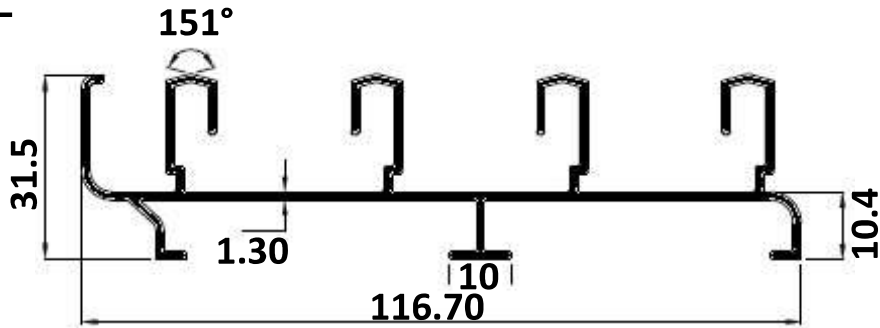

Wt: 4.180KG/12'

RA-02
20 X 54

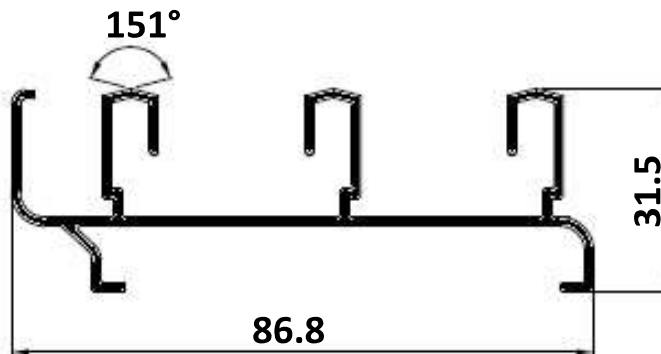

Wt: 3.090 KG/12'

RA-03
20 X 54

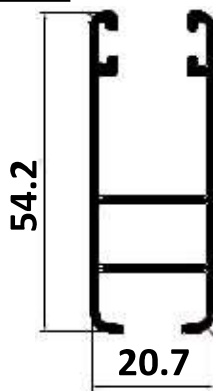

Wt: 2.040 KG/12'

RA-04
20 X 54

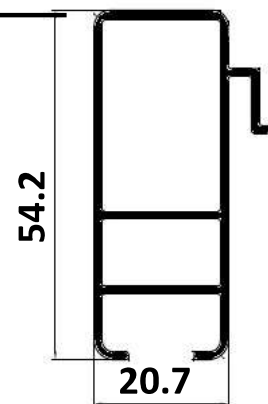

Wt: 2.390-2.490 KG/12'

Domal-1153 Shutter

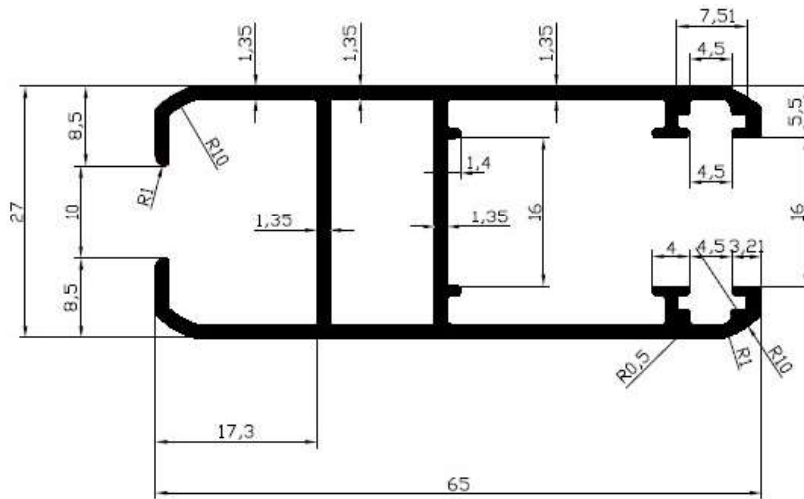

Wt: 2.900 KG/12'

Domal-1154 Double Glass Shutter

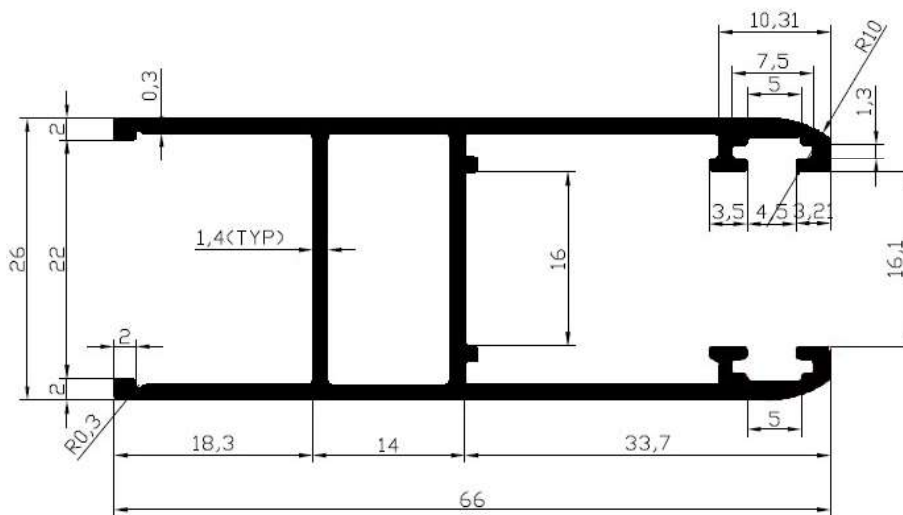

Wt: 2.820 KG/12'

Z Mullion

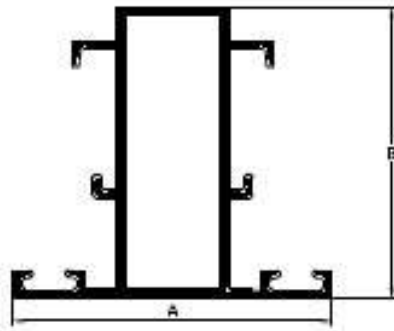

Wt: 2.200KG/12'

Z-Shutter

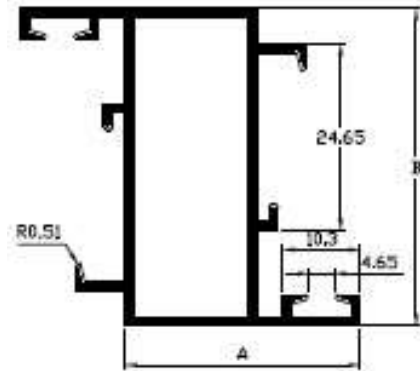

Wt: 2.163 KG/12'

Z-Frame

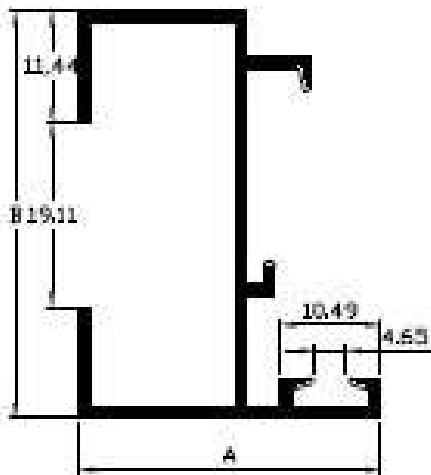

Wt: 1.880KG/12'

Z-Clip

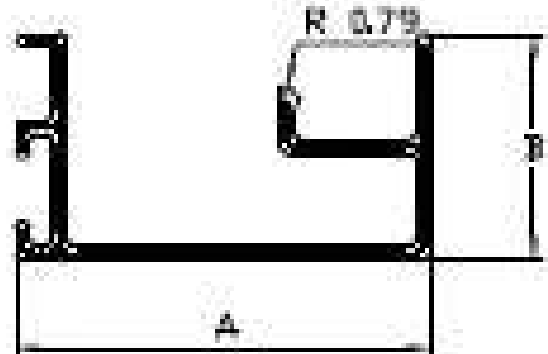

Wt: 0.710KG/12'

Lower Patti

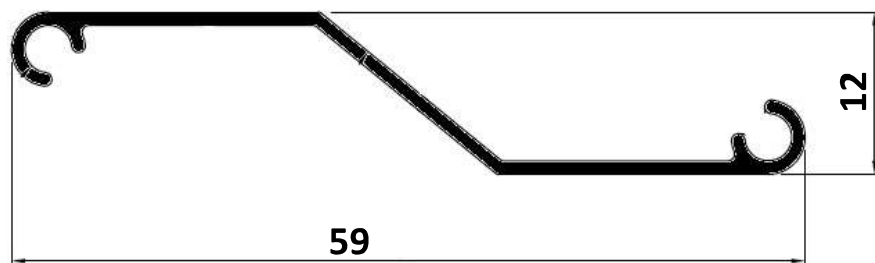

Wt: 0.750KG/12'

1140
Molding Pipe

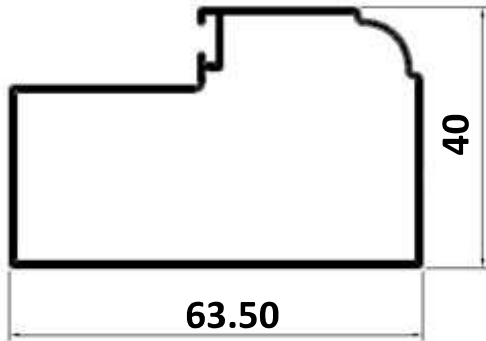

Wt: 1.880KG/12'

F Channel

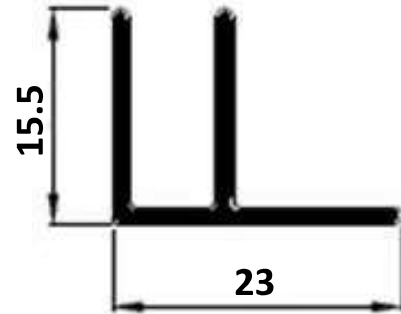

Wt: 0.700 KG/12'

U Section

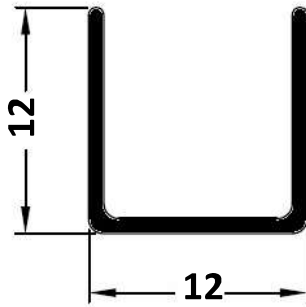

Wt: 0.280KG/12'

U Section

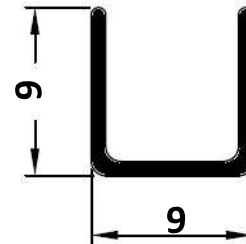

Wt: 0.200KG/12'

KG-1

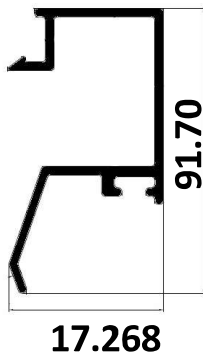

Wt: 0.750-0.800 KG/12'

KG-2

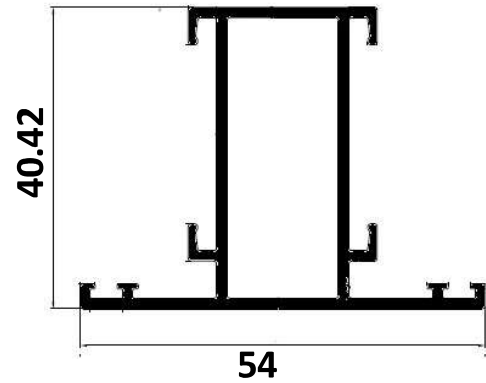

Wt: 2.250-2.260 KG/12'

KG-3

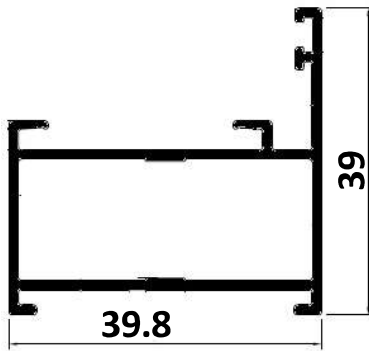

Wt: 1.900-2.000 KG/12'

KG-4

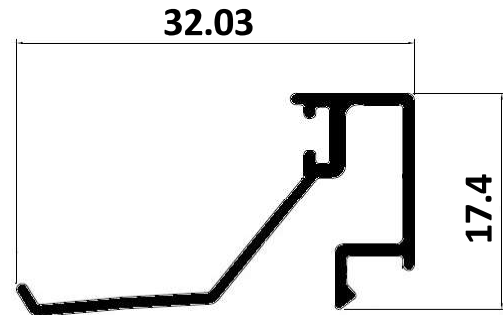

Wt: 0.700-0.770 KG/12'

KG-5

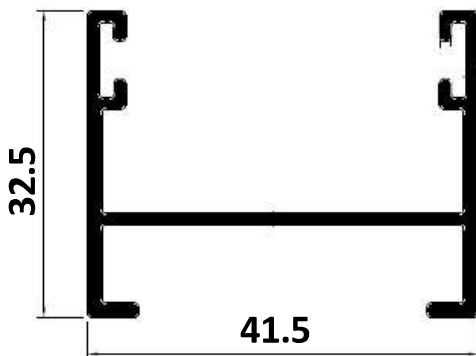

Wt: 1.200-1.300 KG/12'

KG-6

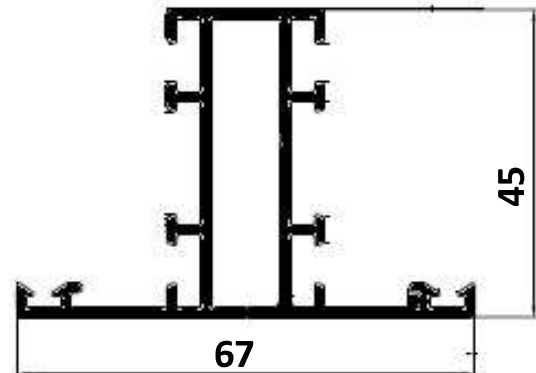

Wt: 0.280 KG/12'

KG-7

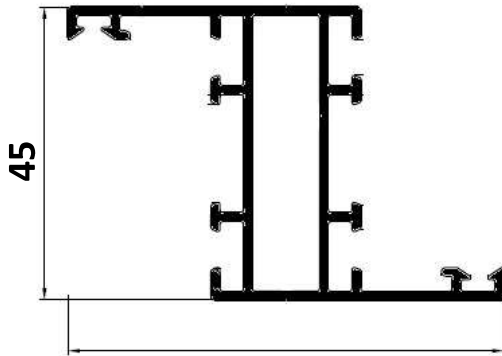

Wt: 3.200-3.300 KG/12'

KG-8

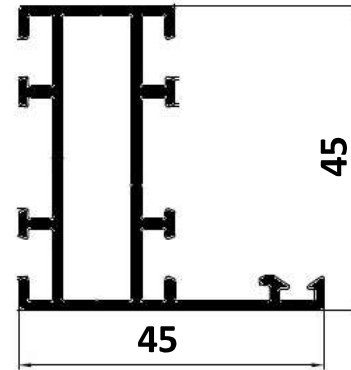

Wt: 2.800-2.900 KG/12'

KG-9

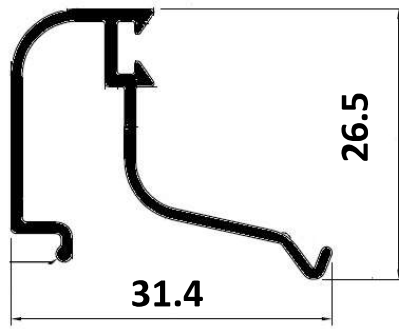

Wt: 0.940-1.000 KG/12'

KG-10

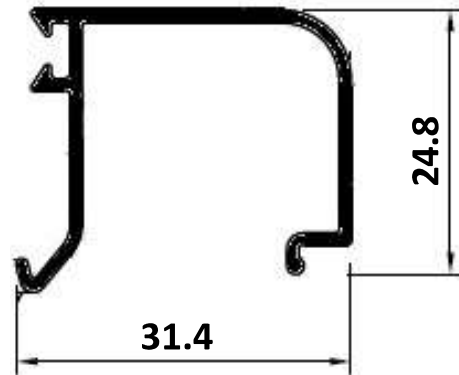

Wt: 1.020-1.120 KG/12'

KG-11

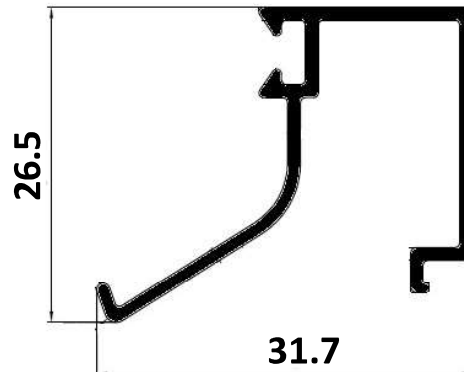

Wt: 0.945-1.045 KG/12'

RN-1

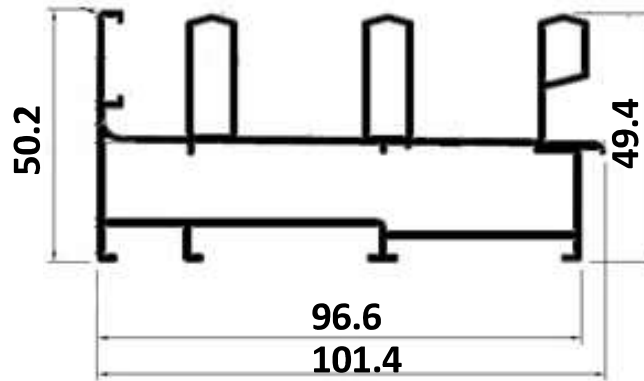

Wt: 6.875-6.975 KG/12'

RN-2

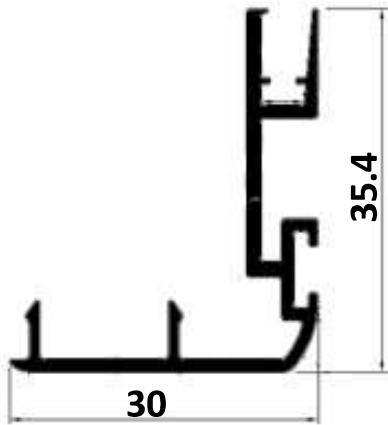

Wt: 1.310-1.410 KG/12'

RN-3

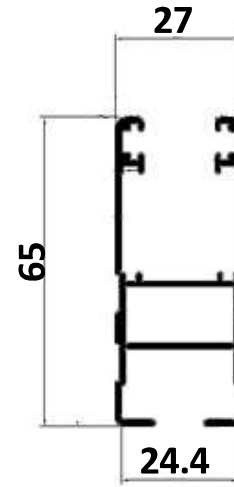

Wt: 3.060-3.160 KG/12'

RN-4

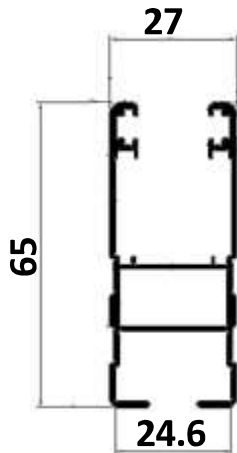

Wt: 2.840-2.940 KG/12'

RN-6

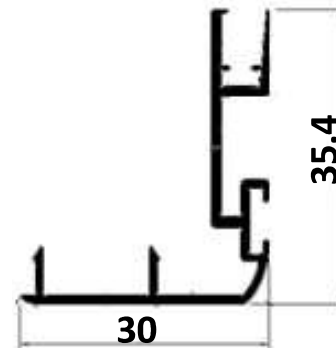

Wt: 1.100-1.200 KG/12'

RA-5

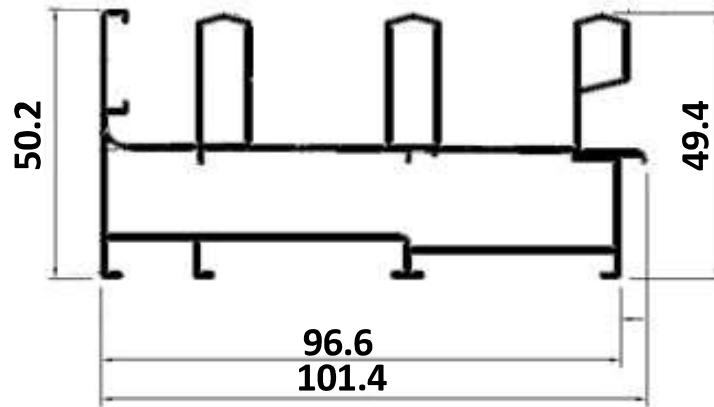

Wt: 5.980-6.280 KG/12'

RA

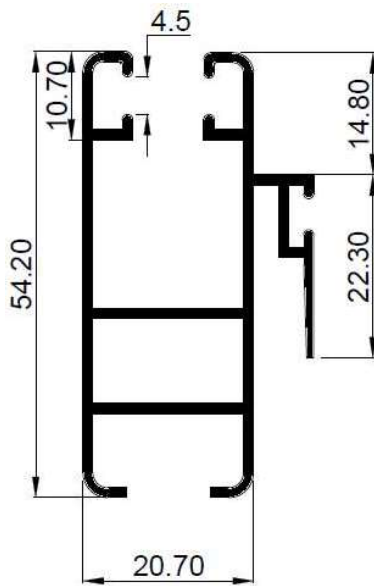

Wt: 2.430 KG/12'

25x65 B.T.B

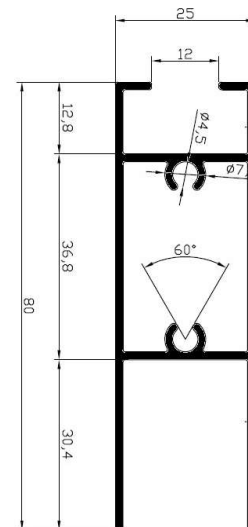

Wt: 3.250-3.350 KG/12'

RAILING PROFILE'S

2151

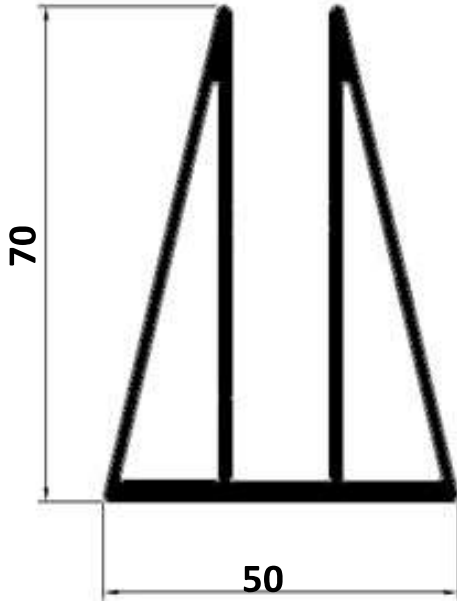

Wt:1.500-1.700 KG/M

2152

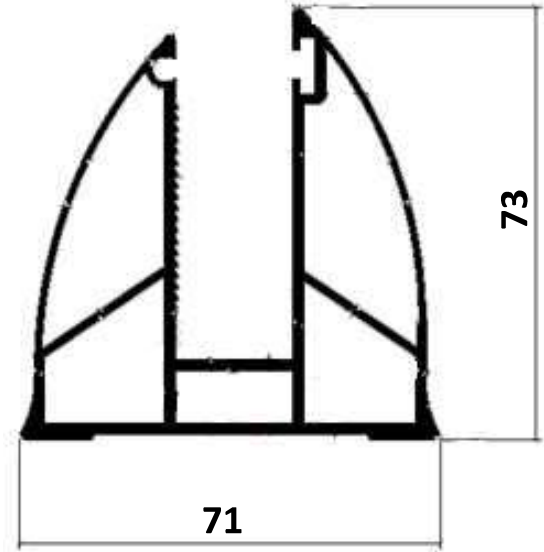

Wt:2.159-2.378 KG/M

2153

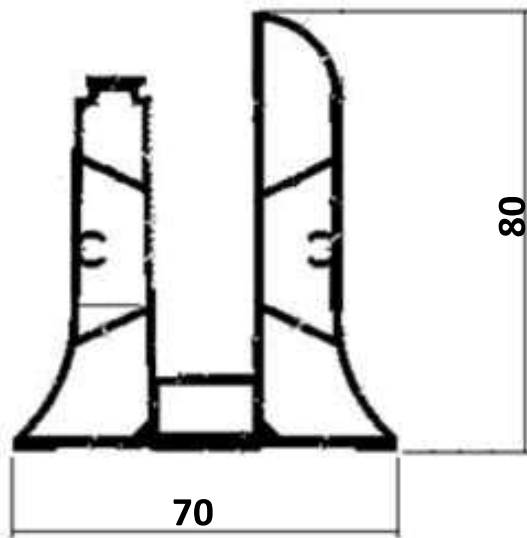

Wt:0.731 KG/M

2154

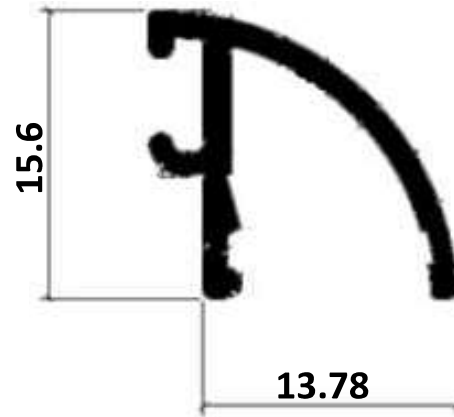

Wt:0.172 KG/M

BLINDS PROFILE'S

CB-01

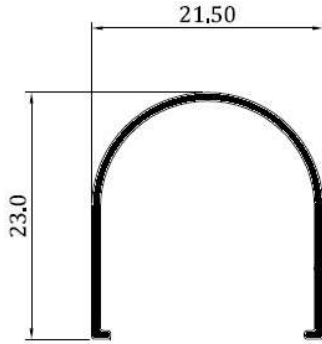

Wt: 0.130 KG/M

CB-02

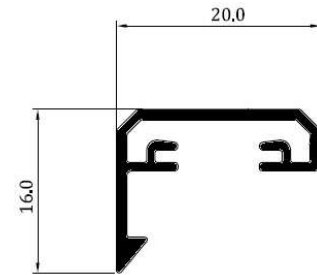

Wt: 0.170 KG/M

CB-03

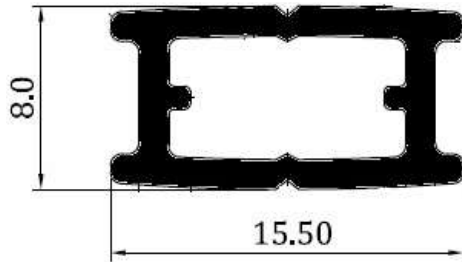

Wt: 0.150 KG/M

CB-04

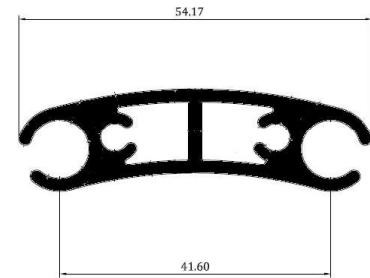

Wt: 0.920 KG/M

CB-05

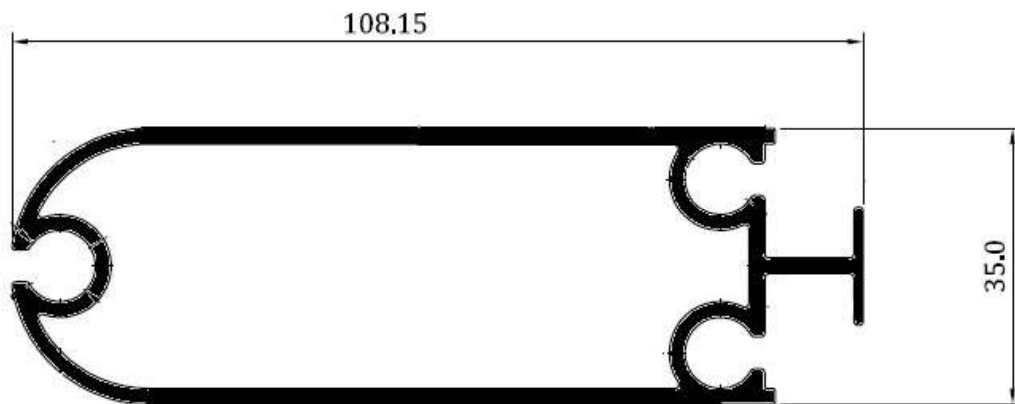

Wt: 0.920 KG/M

HINGE'S PROFILE

9251

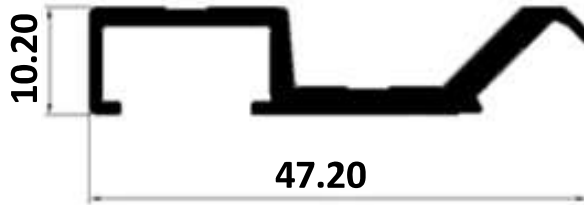

Wt: 0.400 KG/M

9252

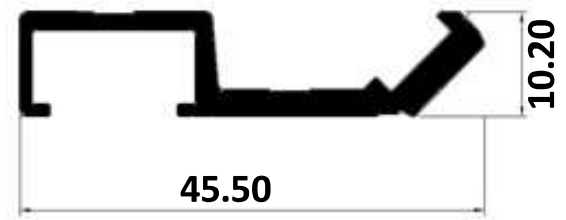

Wt: 0.410 KG/M

9253

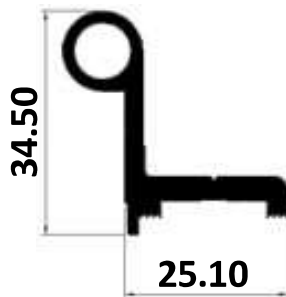

Wt: 0.620 KG/M

9254

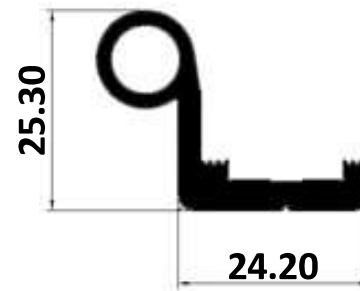

Wt: 0.550 KG/M

9224

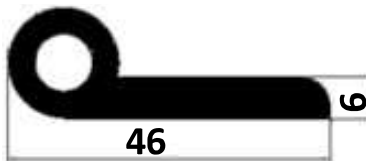

Wt: 0.923 KG/M

9225

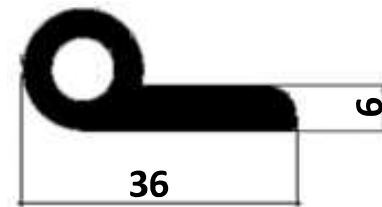

Wt: 0.758 KG/M

9226

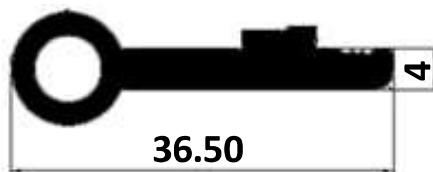

Wt: 0.400 KG/M

9243

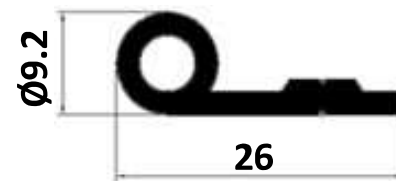

Wt: 0.245 KG/M

LADDER PROFILE'S

2501

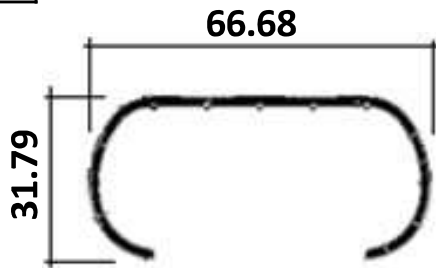

Wt: 2.34KG/12'

2502

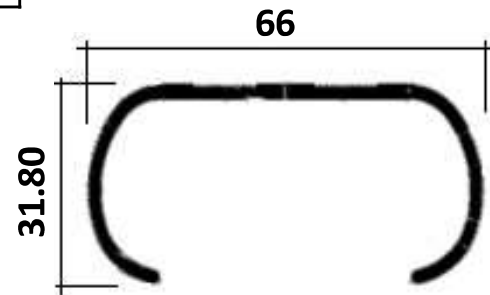

Wt: 2.79KG/12'

2503

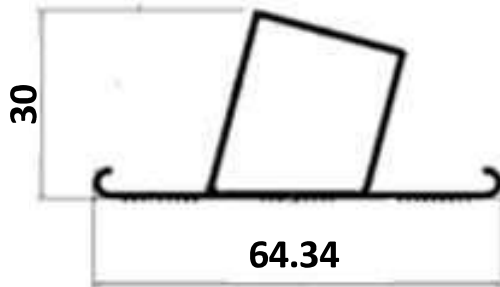

Wt: 1.752-1.934 KG/12'

2504

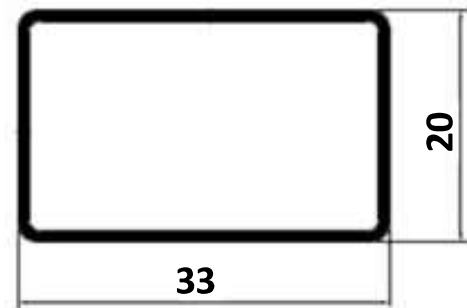

Wt: 0.930-0.985 KG/12'

2505

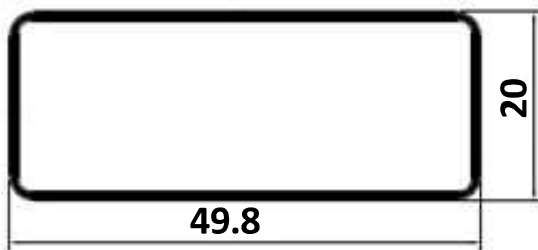

Wt: 2.192-2.415 KG/12'

2506

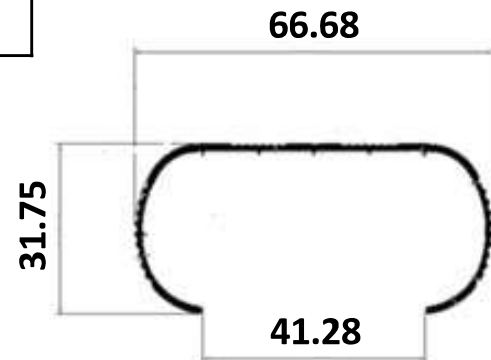

Wt: 1.655-1.744 KG/12'

2507

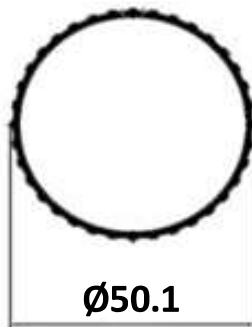

Wt: 2.349-2.598 KG/12'

2508

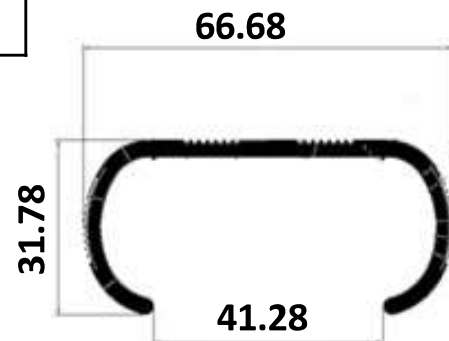

Wt: 3.346KG/12'

2509

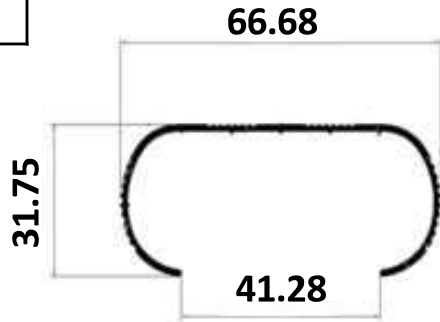

Wt: 0.996-1.139 KG/12'

2510

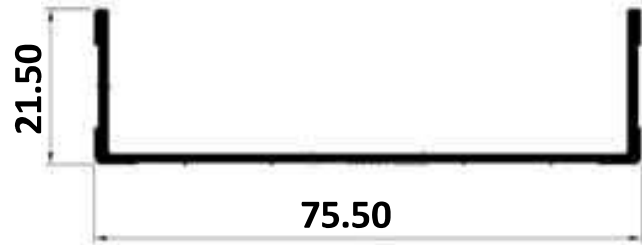

Wt: 1.637 KG/12'

2511

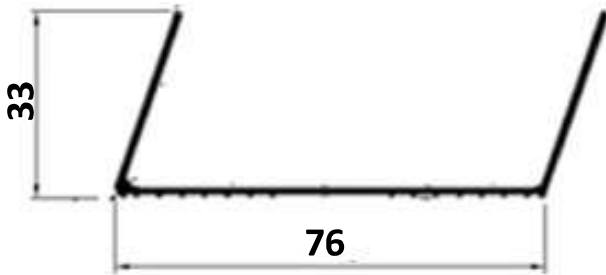

Wt: 2.136 KG/12'

2512

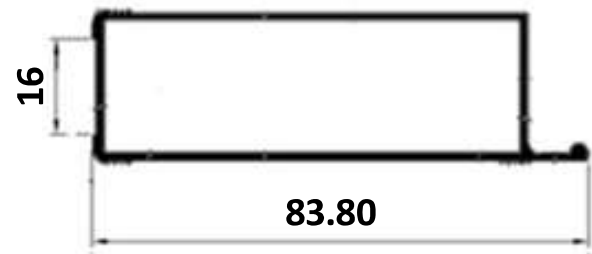

Wt: 2.741-2.997 KG/12'

2513

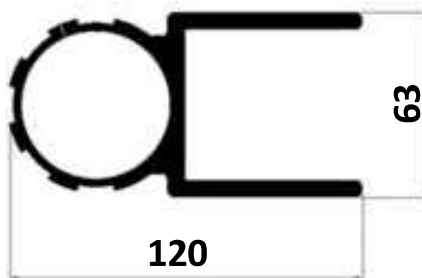

Wt: 16.89 KG/12'

2514

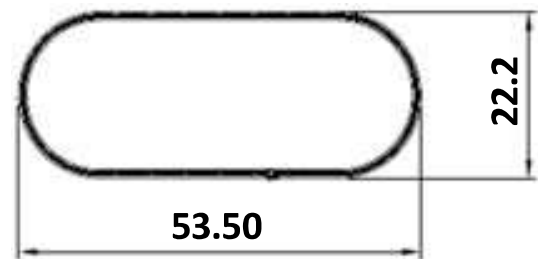

Wt: 1.387 KG/12'

2515

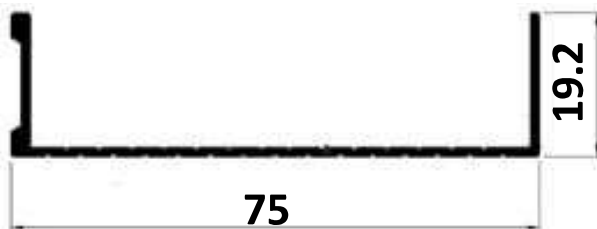

Wt: 1.514 KG/12'

2516

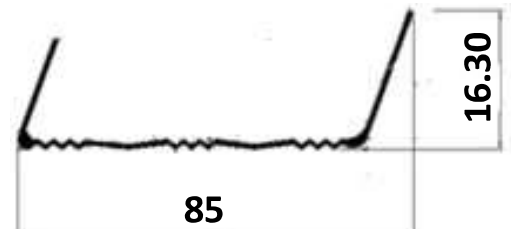

Wt: 1.770 KG/12'

2517

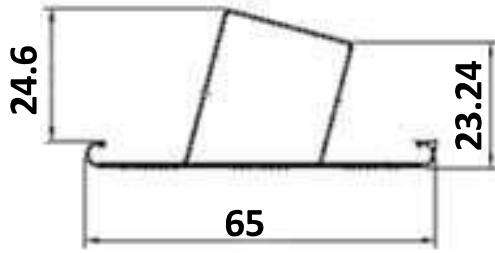

Wt: 1.427-1.441 KG/12'

2518

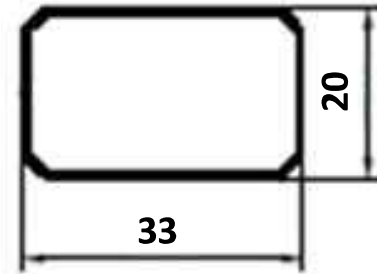

Wt: 0.861-0.876 KG/12'

2519

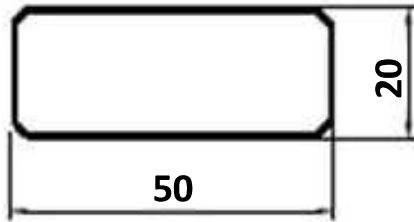

Wt: 1.149 KG/12'

2520

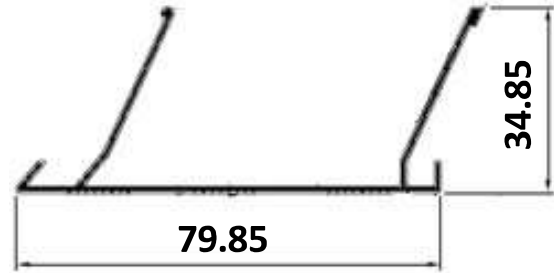

Wt: 1.992-2.193 KG/12'

2521

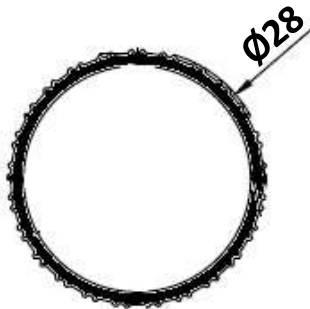

Wt: 1.200-1.350 KG/12'

2522

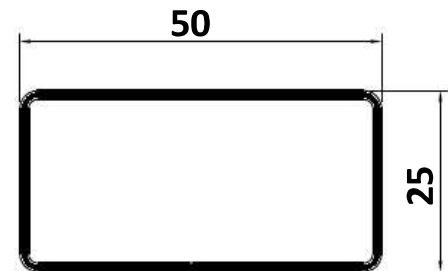

Wt: 3.059 KG/12'

SCAFOLDING
&
FORMWORK
PROFILES
(6061-6082)

2551

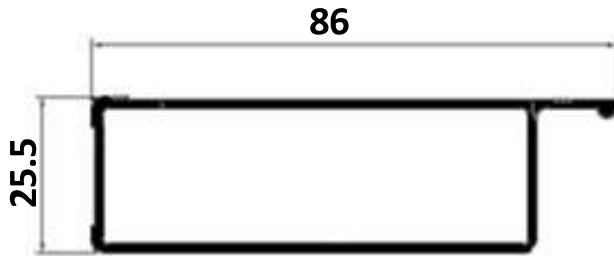

Wt: 0.800 KG/M

2552

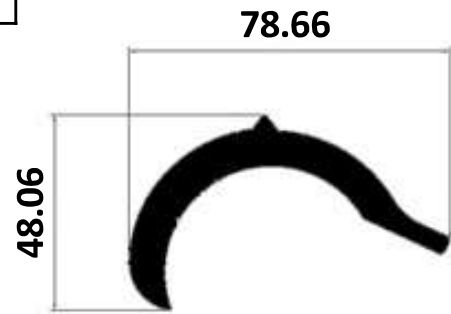

Wt: 2.510 KG/M

2553

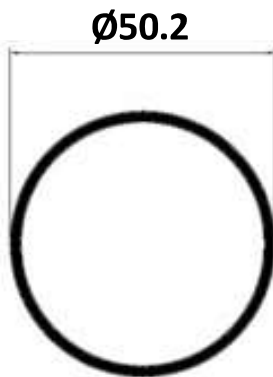

Wt: 0.860 KG/M

2554

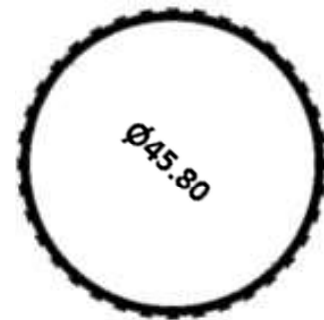

Wt: 0.740 KG/M

2355

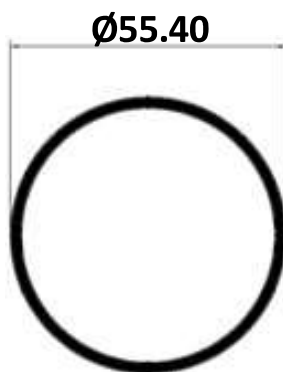

Wt: 1.060 KG/M

2356

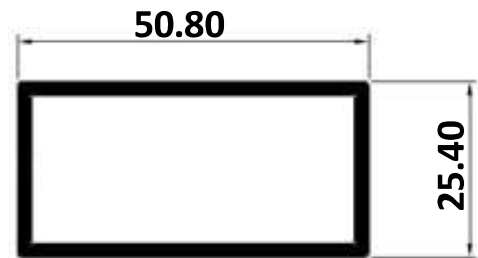

Wt: 0.780 KG/M

2357

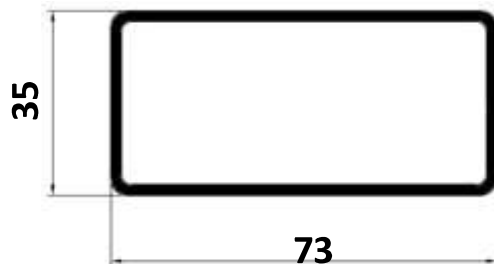

Wt: 1.120 KG/M

2358

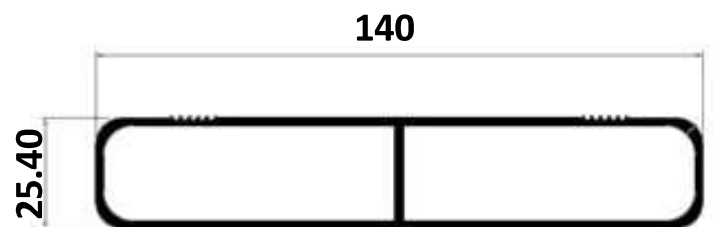

Wt: 2.400 KG/M

2559

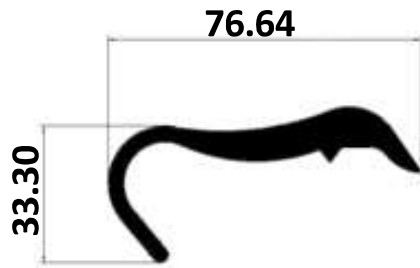

Wt: 1.720 KG/M

2560

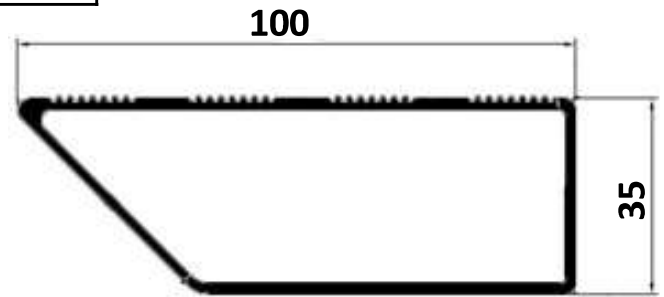

Wt: 1.280 KG/M

2561

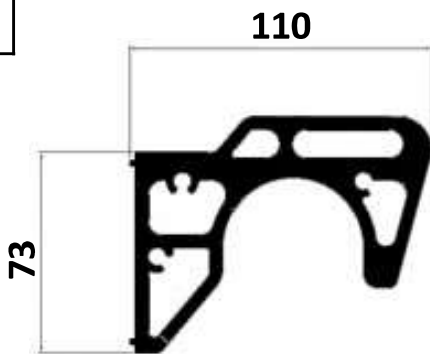

Wt: 7.600 KG/M

2581

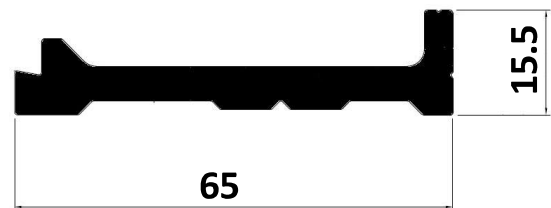

Wt: 1.213 KG/M

2882

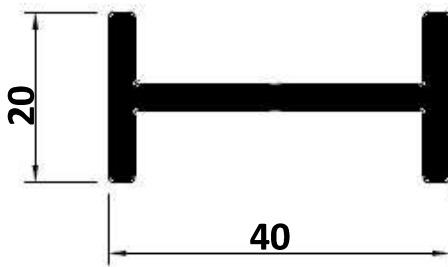

Wt: 0.598 KG/M

2583



Wt: 0.011 KG/M

2584

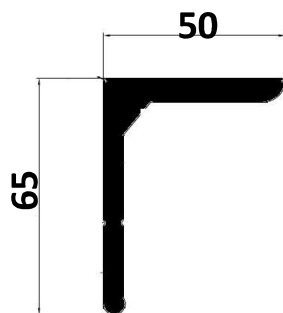

Wt: 1.810-1.950 KG/M

2585

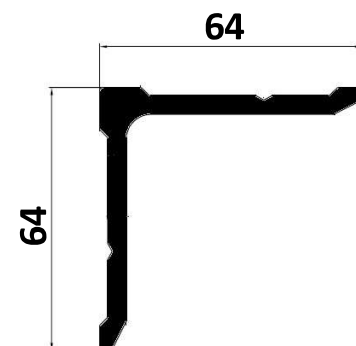

Wt: 1.580-1.680 KG/M

2586

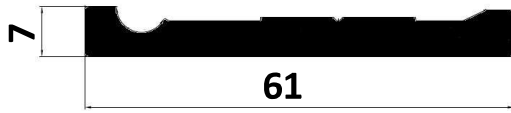

Wt: 0.930-1.000KG/M

2587

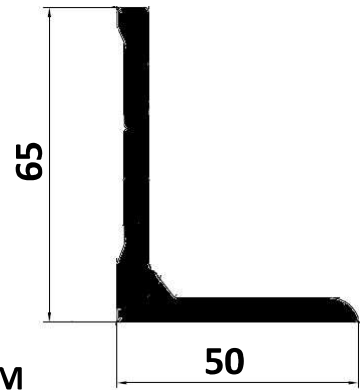

Wt: 1.576 KG/M

2588

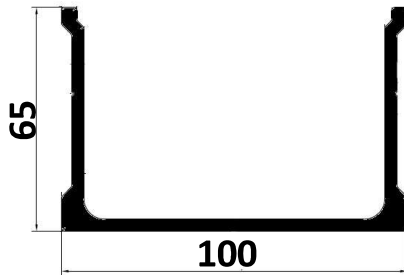

Wt: 2.327 KG/M

2589

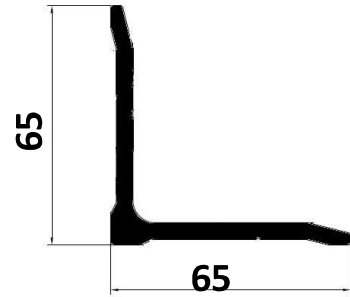

Wt: 1.565 KG/M

2590

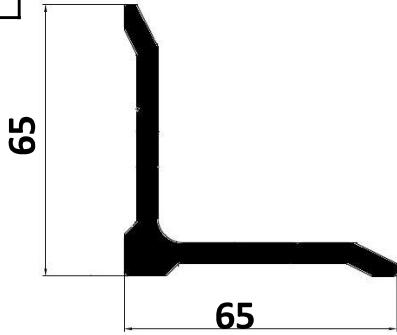

Wt: 1.798 KG/M

2591

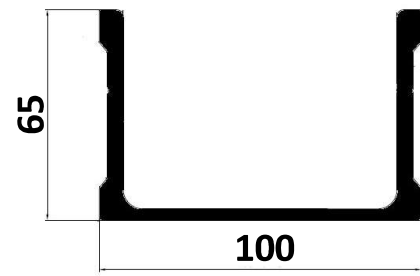

Wt: 2.904 KG/M

2592

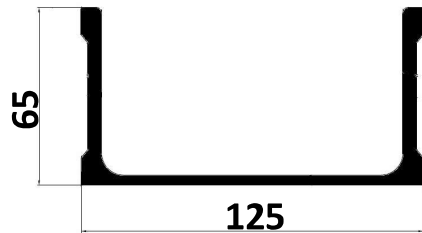

Wt: 2.232 KG/M

2593

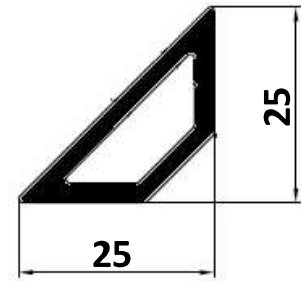

Wt: 0.461 KG/M

2594

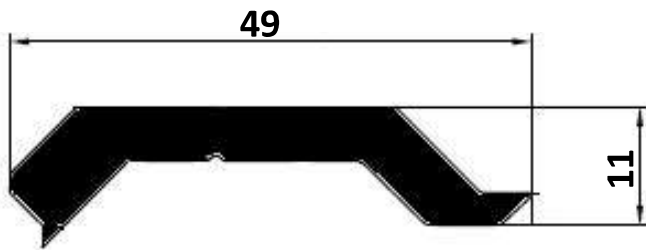

Wt: 0.737 KG/M

2595

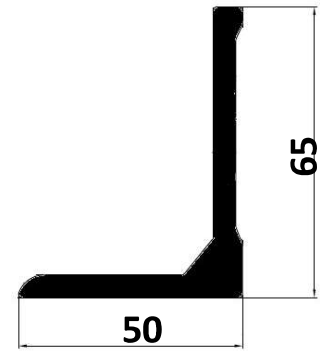

Wt: 1.598 KG/M

2596

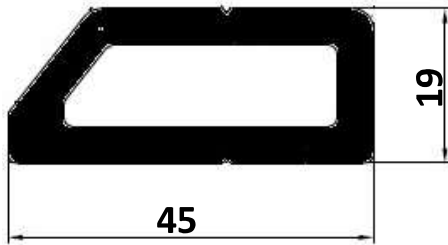

Wt: 1.270 KG/M

2597

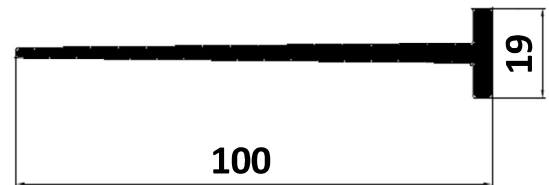

Wt: 0.980 KG/M